







# GINGER XL-H

*Big size spotlight for recessed installations  
into the ground / floor.*

	<b>CRI</b>		<b>lm</b>	<b>lm/w</b>				
IP 67	70-90 CRI	8.4W	792lm	95lm/w	9/20/28/37/40°	2700K 6500K	Mono/RGBW	RAL Anodized

**GINGER XL** is a line of spotlights designed with leading-edge technology. The series of spots includes various installation options with a custom design mounting system. The light output of the unit ranges from 660 to 1130 Lumen thanks to the Luxeon M LED. Furthermore, the unit's dark-light design ensures pure light without glare.

**GINGER XL** has a smart design, incorporating a unique cooling method, and a concealed cable PG, to provide a slim cutout where its anodized color lends the final touch of an artist. The **GINGER XL** is also optional in RGBW configuration.

**Ginger XL H** is a bigger size spotlight for recessed installations into the ground / floor. This line is ideal for illuminating facades and niches, spas and pool areas, landscape lighting and scenery, counters and shelves, indoor and outdoor use, at home and/or in the office.

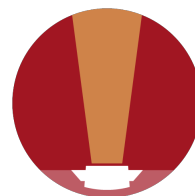

## OUTPUT

LED System	OSRAM Multi Color LED or Luxeon M white
Intensity	740 lm @ full power CRI 90 3000k
Channel Range	1 / 4 Channels
Color Range	2700K / 3000K / 4000K / 7000K / RGBW
Optical System	9 / 22 / 28 / 37 / OVAL 48X20 FOR WHITE 28 / OVAL FOR RGBW(4000K)

## ENVIRONMENTAL

Control	Constant current driver / 24V with Mini CC2CB
Input Voltage	6V/1400mA & 12V/700mA
Consumption	8.4W
Max LED's	1 LED
Efficiency LM/W	95lm/w @ 4000K 80CRI @ 700mA
Connection	22AWG 2C Concealed cable PG

## PHYSICAL

IP Rating	IP 67
Working Temp.	-18°C ~ 40°C / 0°F ~ 104°F
Storage Temp.	-18°C ~ 60°C / 0°F ~ 140°F

## PHYSICAL

Size	H75mm * Ø66mm
Housing	Anodized Aluminum

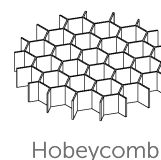
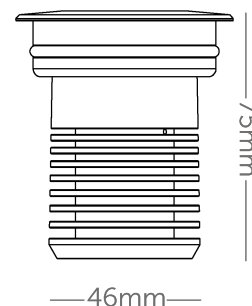
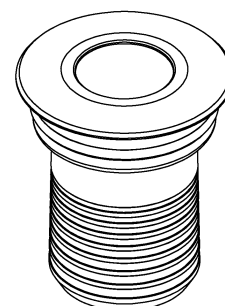

# TECHNICAL SPECIFICATION